

INSTRUCTIONS

TWA NO

088R0248

088R0248

TWA-A

for Danfoss RA valves

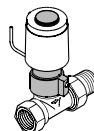
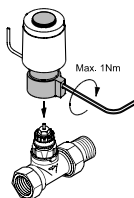

TWA-V

For Danfoss RAV/VMT valves

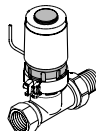
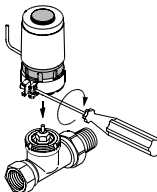

TWA-L

For Danfoss RAVL valves

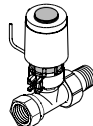
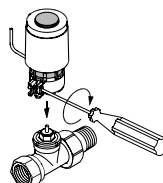

TWA-K

For valves with
Heimeier/MNG/Oventrop
M30 x 1.5 connection

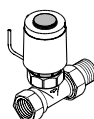
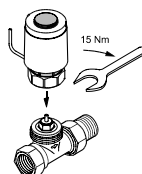

NO

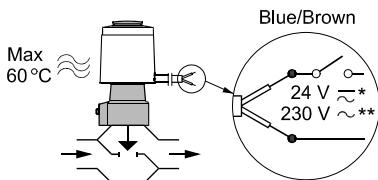

*) 24 V Class II transformer (SELV)

**) 230 V max. 3 A pre-fuse

IP 41

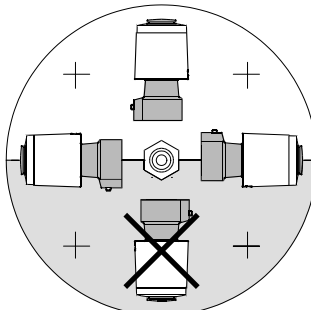

INSTRUCTIONS

TWA NC

088R0248

088R0248

TWA-A

for Danfoss RA valves

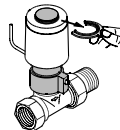
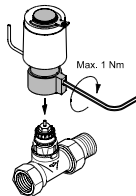

TWA-V

For Danfoss RAV/VMT valves

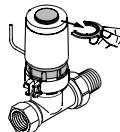
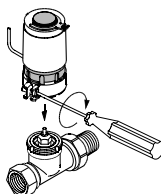

TWA-L

For Danfoss RAVL valves

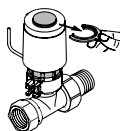
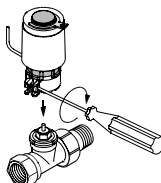

TWA-K

For valves with
Heimeier/MNG/Oventrop
M30 x 1.5 connection

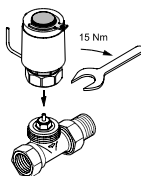

NC

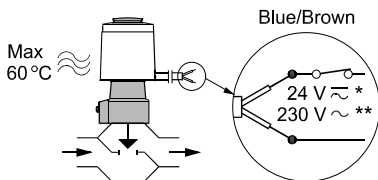

*) 24 V Class II transformer (SELV)

**) 230 V max. 3 A pre-fuse

IP 41

